

HEAVY DUTY

INDUSTRIAL BURNER

RAMVER Industrial Burner is a specialized device designed for efficiently and precisely combusting fuels in industrial processes such as manufacturing, heating, or power generation.



BEST PERFORMANCE



STABLE & DURABLE



WORK EFFICIENCY



EASY OPERATION

TABLE OF CONTENT

PAGE 01

RMR85/120FGR

PAGE 04

RMR210/250FGR

PAGE 07

RMR400/600FGR

PAGE 10

RMR800/1000FGR

PAGE 13

RMR1200/1500/1800FGR

PAGE 16

RMR40GP

PAGE 18

RMR85/120GP

PAGE 20

RMR210/250GP

PAGE 22

RMR400/600GP

RMR85/120FGR

RAMVER FUEL GAS EXTERNAL CIRCULATION COMBUSTION SYSTEM



BEST PERFORMANCE



STABLE & DURABLE



WORK EFFICIENCY



EASY OPERATION



Product Description

1. Super low NOx gas burner.
2. Digital burner management system. Two-stage sliding / modulating working.
3. Smoke external cycle system, mixing part smoke and supporting air which decreases combustion temperature and oxygen content, to limit the Nox s coming out.
4. Multiple gas pipes, non-central combustion, in case of high oxidation.
5. Use 3 pcs servo motor, control supporting-air flow, gas flow and smoke flow ratio accurately.
6. Use flange and high temperature proof gasket to connect with boiler.
7. Three-phase electric motor to run fan.
8. UV photocell checks the flame.
9. Electrical plant protection rating IP40.

RMR85/120FGR

RAMVER FUEL GAS EXTERNAL CIRCULATION COMBUSTION SYSTEM

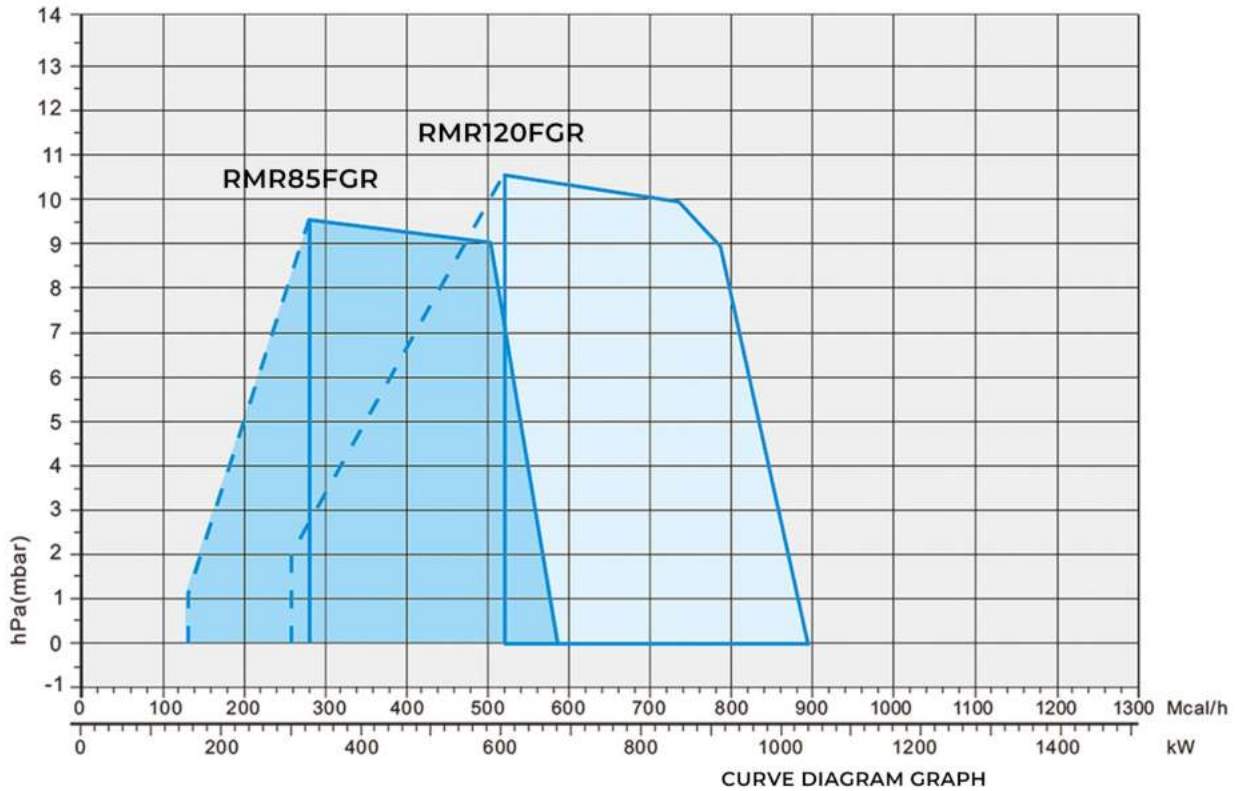

| Power | Model | Power Supply | Motor Power | Packing Size LxPxH | Net Weight |
|-------------|--------------|--------------|-------------|--------------------|------------|
| 150~688 KW | RMR85FGR TC | 380V 50Hz | 1.5 KW | 1000x1010x755 mm | 78 Kg |
| 300~1040 KW | RMR120FGR TC | 380V 50Hz | 2.2 KW | 1000x1010x755 mm | 81 Kg |
| 150~688 KW | RMR85FGR TL | 380V 50Hz | 1.5 KW | 1000x1010x755 mm | 78 Kg |
| 300~1040 KW | RMR120FGR TL | 380V 50Hz | 2.2 KW | 1000x1010x755 mm | 81 Kg |

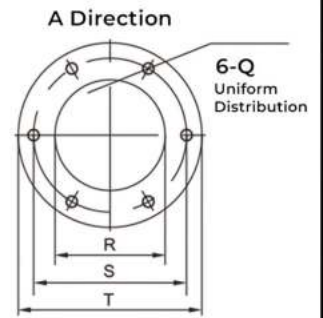
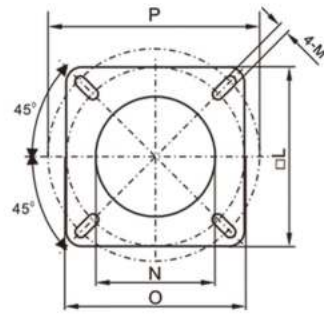
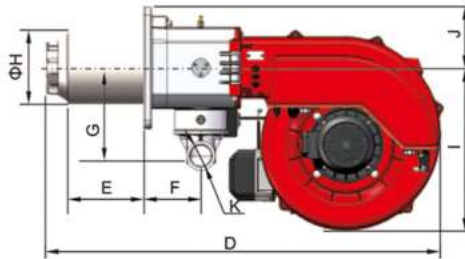

Boiler Opening Size

Flue Gas Interface Flange

| Model | RMR85FGR TC | RMR120FGR TC | RMR85FGR TL | RMR120FGR TL |
|-------|-------------|--------------|-------------|--------------|
| A | 352 mm | 352 mm | 352 mm | 352 mm |
| B | 234 mm | 234 mm | 234 mm | 234 mm |
| C | 320 mm | 320 mm | 320 mm | 320 mm |
| D | 1040 mm | 1040 mm | 1040 mm | 1040 mm |
| E | 200 m | 200 m | 335 m | 335 m |
| F | 151 mm | 151 mm | 151 mm | 151 mm |
| G | 231 mm | 231 mm | 231 mm | 231 mm |
| H | φ 190 mm | 190 mm | 190 mm | 190 mm |
| I | 427 mm | 427 mm | 427 mm | 427 mm |
| J | 160 mm | 160 mm | 160 mm | 160 mm |
| K | G2" | G2" | G2" | G2" |
| L | 320 mm | 320 mm | 320 mm | 320 mm |
| M | 4-M16 m | 4-M16 m | 4-M16 m | 4-M16 m |
| N | φ 200 mm | φ 200 mm | φ 200 mm | φ 200 mm |
| O | φ 290 mm | φ 290 mm | φ 290 mm | φ 290 mm |
| P | φ 370 mm | φ 370 mm | φ 370 mm | φ 370 mm |
| Q | φ 9 mm | φ 9 mm | φ 9 mm | φ 9 mm |
| R | φ 90 mm | φ 90 mm | φ 90 mm | φ 90 mm |
| S | φ 125 mm | φ 125 mm | φ 125 mm | φ 125 mm |
| T | φ 150 mm | φ 150 mm | φ 150 mm | φ 150 mm |

RMR210/250FGR

RAMVER FUEL GAS EXTERNAL CIRCULATION COMBUSTION SYSTEM



BEST PERFORMANCE



STABLE & DURABLE



WORK EFFICIENCY



EASY OPERATION



Product Description

1. Super low NOx gas burner.
2. Digital burner management system. Two-stage sliding / modulating working.
3. Smoke external cycle system, mixing part smoke and supporting air which decreases combustion temperature and oxygen content, to limit the Nox s coming out.
4. Multiple gas pipes, non-central combustion, in case of high oxidation.
5. Use 3 pcs servo motor, control supporting-air flow, gas flow and smoke flow ratio accurately.
6. Use flange and high temperature proof gasket to connect with boiler.
7. Three-phase electric motor to run fan.
8. UV photocell checks the flame.
9. Electrical plant protection rating IP40.

RMR210/250FGR

RAMVER FUEL GAS EXTERNAL CIRCULATION COMBUSTION SYSTEM

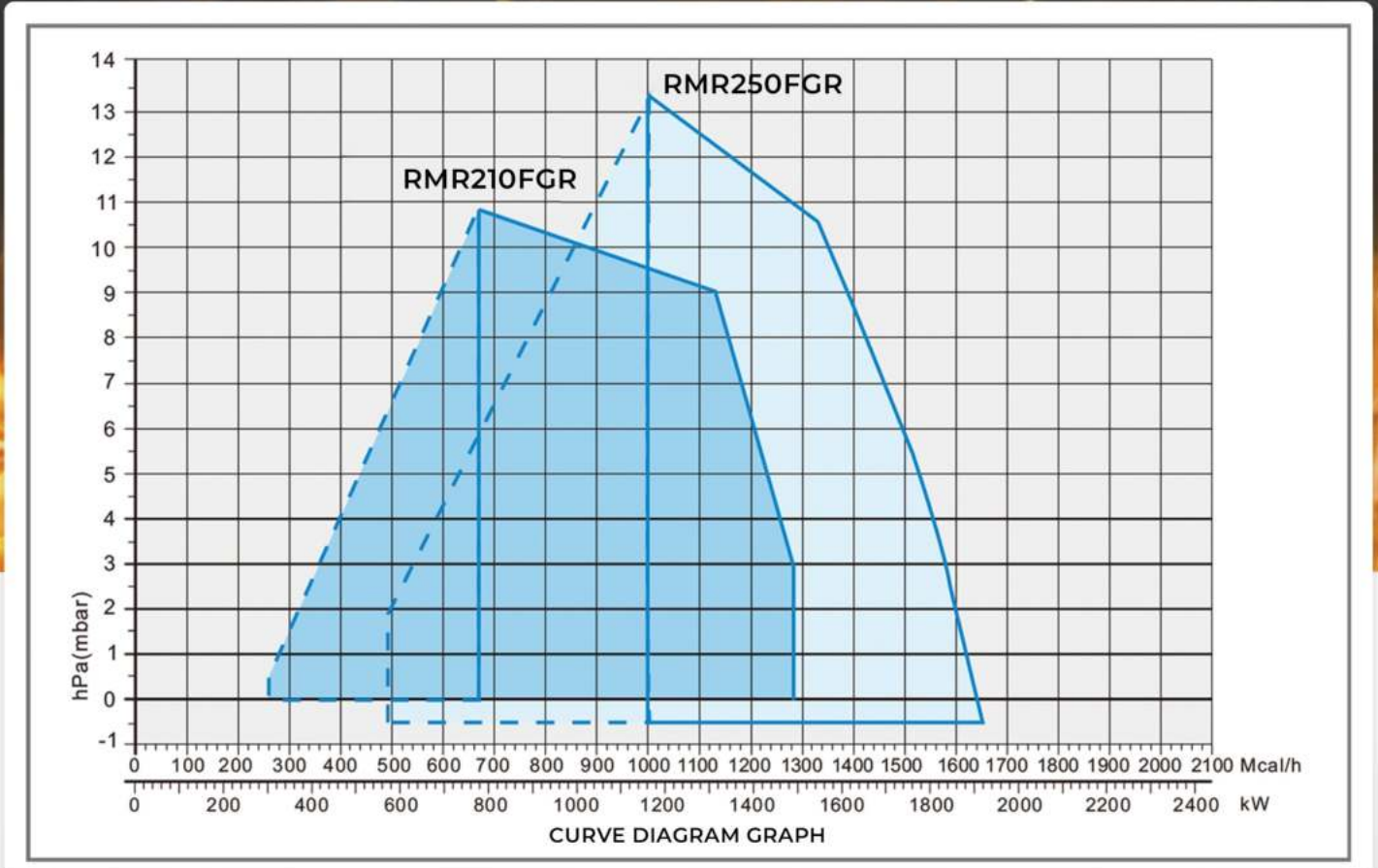

| Power | Model | Power Supply | Motor Power | Packing Size LxPxH | Net Weight |
|-------------|--------------|--------------|-------------|--------------------|------------|
| 300~1488 KW | RMR210FGR TC | 380V 50Hz | 4.5 KW | 1000x1010x755 mm | 89 Kg |
| 570~1920 KW | RMR250FGR TC | 380V 50Hz | 5.5 KW | 1000x1010x755 mm | 125 Kg |
| 300~1488 KW | RMR210FGR TL | 380V 50Hz | 4.5 KW | 1000x1010x755 mm | 89 Kg |
| 570~1920 KW | RMR250FGR TL | 380V 50Hz | 5.5 KW | 1000x1010x755 mm | 125 Kg |

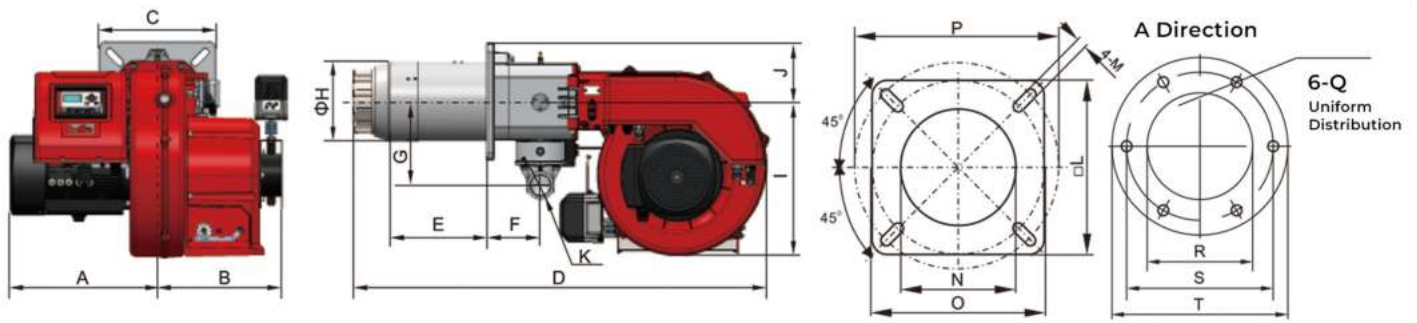

Boiler Opening Size Flue Gas Interface Flange

| Model | RMR210FGR TC | RMR250FGR TC | RMR210FGR TL | RMR250FGR TL |
|-------|--------------|--------------|--------------|--------------|
| A | 403 mm | 403 mm | 403 mm | 403 mm |
| B | 356 mm | 356 mm | 356 mm | 356 mm |
| C | 320 mm | 320 mm | 320 mm | 320 mm |
| D | 1165 mm | 1165 mm | 1165 mm | 1165 mm |
| E | 270 m | 270 m | 405 m | 405 m |
| F | 151 mm | 151 mm | 151 mm | 151 mm |
| G | 231 mm | 231 mm | 231 mm | 231 mm |
| H | φ 222 mm | φ 222 mm | φ 222 mm | φ 222 mm |
| I | 427 mm | 427 mm | 427 mm | 427 mm |
| J | 160 mm | 160 mm | 160 mm | 160 mm |
| K | G2" | G2" | G2" | G2" |
| L | 320 mm | 320 mm | 320 mm | 320 mm |
| M | 4-M16 m | 4-M16 m | 4-M16 m | 4-M16 m |
| N | φ 232 mm | φ 232 mm | φ 232 mm | φ 232 mm |
| O | φ 290 mm | φ 290 mm | φ 290 mm | φ 290 mm |
| P | φ 370 mm | φ 370 mm | φ 370 mm | φ 370 mm |
| Q | φ 9 mm | φ 9 mm | φ 9 mm | φ 9 mm |
| R | φ 110 mm | φ 110 mm | φ 110 mm | φ 110 mm |
| S | φ 150 mm | φ 150 mm | φ 150 mm | φ 150 mm |
| T | φ 180 mm | φ 180 mm | φ 180 mm | φ 180 mm |

RMR400/600FGR

RAMVER FUEL GAS EXTERNAL CIRCULATION COMBUSTION SYSTEM



BEST PERFORMANCE



STABLE & DURABLE



WORK EFFICIENCY



EASY OPERATION



Product Description

1. Super low NOx gas burner.
2. Digital burner management system. Two-stage sliding / modulating working.
3. Smoke external cycle system, mixing part smoke and supporting air which decreases combustion temperature and oxygen content, to limit the Nox s coming out.
4. Multiple gas pipes, non-central combustion, in case of high oxidation.
5. Use 3 pcs servo motor, control supporting-air flow, gas flow and smoke flow ratio accurately.
6. Use flange and high temperature proof gasket to connect with boiler.
7. Three-phase electric motor to run fan.
8. UV photocell checks the flame.
9. Electrical plant protection rating IP40.

RMR400/600FGR

RAMVER FUEL GAS EXTERNAL CIRCULATION COMBUSTION SYSTEM

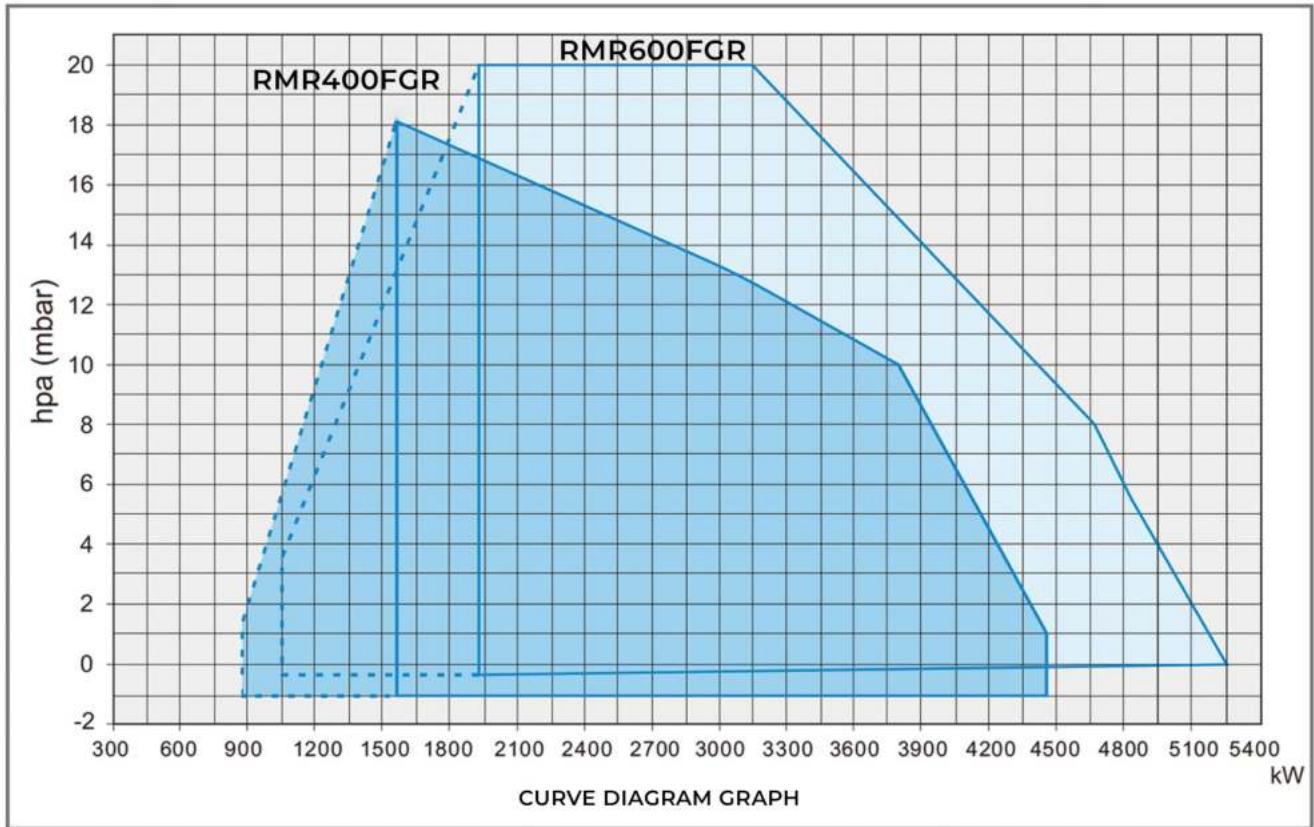

| Power | Model | Power Supply | Motor Power | Packing Size LxPxH | Net Weight |
|--------------|-----------|--------------|-------------|--------------------|------------|
| 890~4450 KW | RMR400FGR | 380V 50Hz | 12.5 KW | 1625x1070x955 mm | 562 Kg |
| 1000~5250 KW | RMR600FGR | 380V 50Hz | 15 KW | 1625x1070x955 mm | 567 Kg |

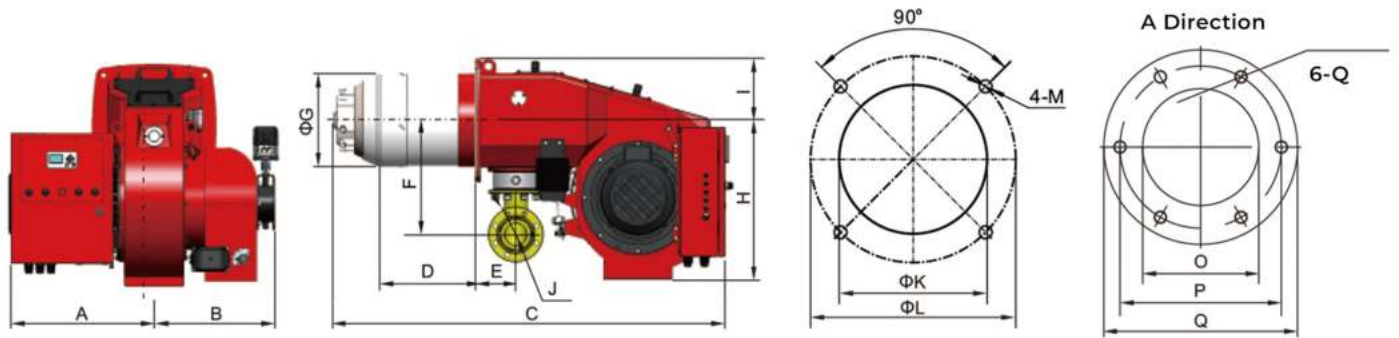

Boiler Opening Size

Flue Gas Interface Flange

| Model | RMR400FGR | RMR600FGR |
|-------|-----------|-----------|
| A | 526 mm | 526 mm |
| B | 450 mm | 450 mm |
| C | 1504 mm | 1504 mm |
| D | 346 mm | 346 mm |
| E | 150 m | 150 m |
| F | 414 mm | 414 mm |
| G | φ 336 mm | φ 336 mm |
| H | 577 mm | 577 mm |
| I | 225 mm | 225 mm |
| J | DN 80 mm | DN 80 mm |
| K | φ 375 mm | φ 375 mm |
| L | φ 520 mm | φ 520 mm |
| M | 4-M16 m | 4-M16 m |
| N | φ 11 mm | φ 11 mm |
| O | φ 125 mm | φ 125 mm |
| P | φ 160 mm | φ 160 mm |
| Q | φ 190 mm | φ 190 mm |

RMR800/1000FGR

RAMVER FUEL GAS EXTERNAL CIRCULATION COMBUSTION SYSTEM



BEST PERFORMANCE



STABLE & DURABLE



WORK EFFICIENCY



EASY OPERATION



Product Description

1. Super low NOx gas burner.
2. Digital burner management system. Two-stage sliding / modulating working.
3. Smoke external cycle system, mixing part smoke and supporting air which decreases combustion temperature and oxygen content, to limit the Nox s coming out.
4. Multiple gas pipes, non-central combustion, in case of high oxidation.
5. Use 3 pcs servo motor, control supporting-air flow, gas flow and smoke flow ratio accurately.
6. Use flange and high temperature proof gasket to connect with boiler.
7. Three-phase electric motor to run fan.
8. UV photocell checks the flame.
9. Electrical plant protection rating IP40.

RMR800/1000FGR

RAMVER FUEL GAS EXTERNAL CIRCULATION COMBUSTION SYSTEM

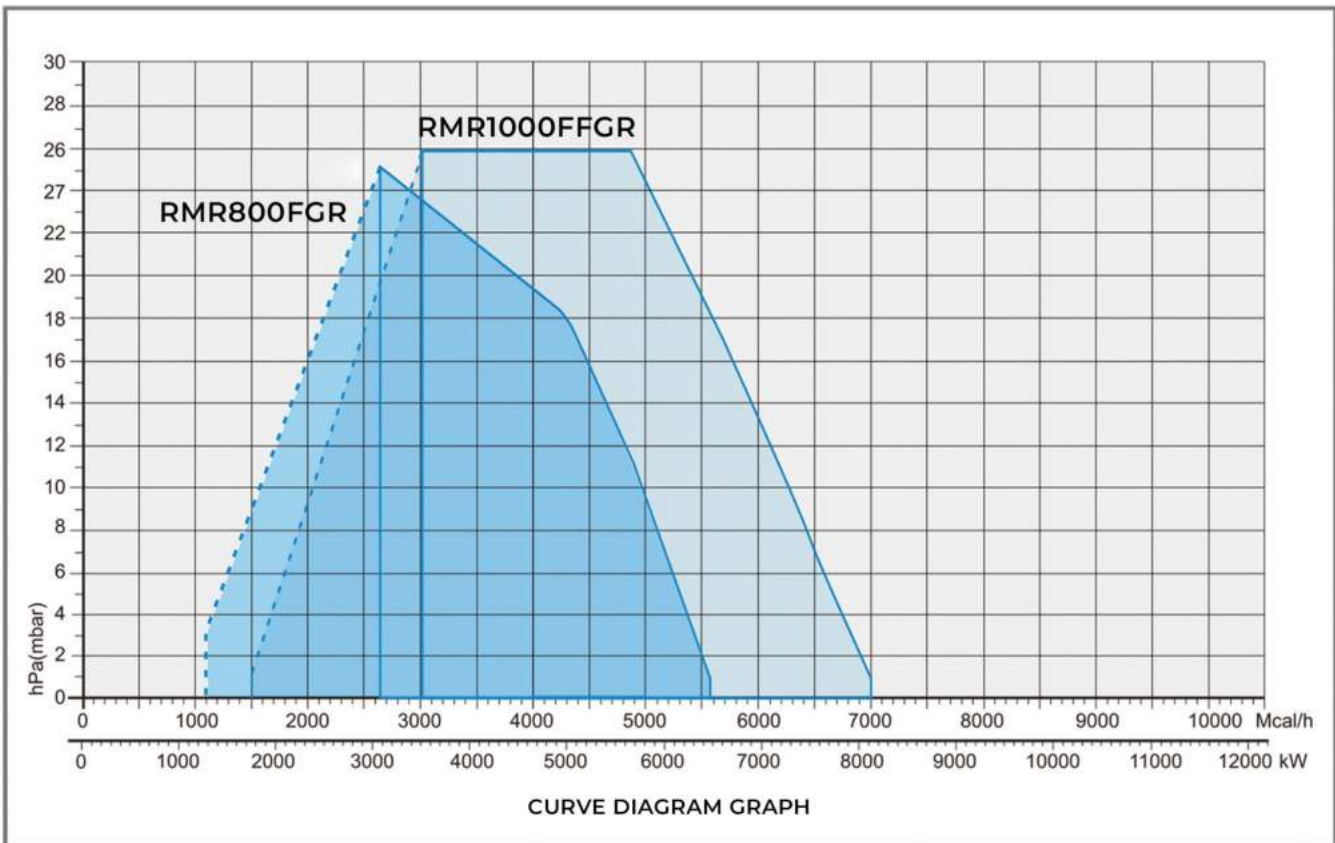

| Power | Model | Power Supply | Motor Power | Packing Size LxPxH | Net Weight |
|--------------|------------|--------------|-------------|--------------------|------------|
| 1200~6480 KW | RMR800FGR | 380V 50Hz | 18.5 KW | 2080x1530x1500 mm | 662 Kg |
| 1600~8080 KW | RMR1000FGR | 380V 50Hz | 22 KW | 2165x1530x1500 mm | 667 Kg |

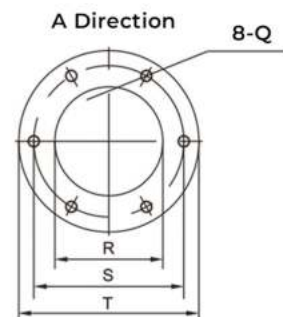
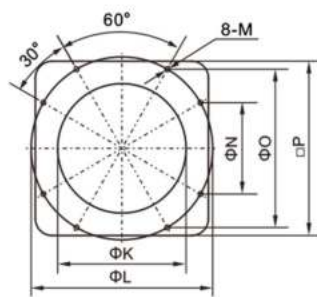
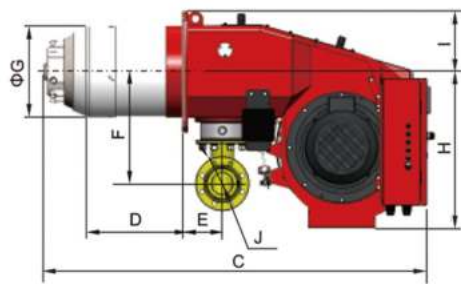
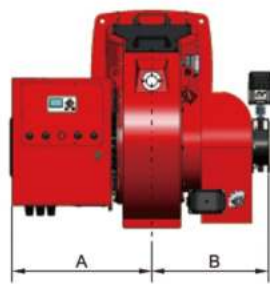

Boiler Opening Size

Flue Gas Interface Flange

| Model | RMR800FGR | RMR1000FGR |
|-------|-----------|------------|
| A | 815 mm | 815 mm |
| B | 668 mm | 668 mm |
| C | 1957 mm | 2045 mm |
| D | 397 mm | 486 mm |
| E | 223 m | 223 m |
| F | 539 mm | 539 mm |
| G | φ 363 mm | φ 413 mm |
| H | 918 mm | 918 mm |
| I | 310 mm | 310 mm |
| J | DN100 mm | DN100 mm |
| K | φ 400 mm | φ 460 mm |
| L | φ 650 mm | φ 650 mm |
| M | 8-M16 m | 8-M16 m |
| N | φ 325 mm | φ 325 mm |
| O | φ 563 mm | φ 563 mm |
| P | φ 620 mm | φ 620 mm |
| Q | φ 14 mm | φ 14 mm |
| R | φ 200 mm | φ 200 mm |
| S | φ 260 mm | φ 260 mm |
| T | φ 300 mm | φ 300 mm |

RMR1200/1500/1800FGR

RAMVER FUEL GAS EXTERNAL CIRCULATION COMBUSTION SYSTEM



BEST PERFORMANCE



STABLE & DURABLE



WORK EFFICIENCY



EASY OPERATION



Product Description

1. Super low NOx gas burner.
2. Digital burner management system. Two-stage sliding / modulating working.
3. Smoke external cycle system, mixing part smoke and supporting air which decreases combustion temperature and oxygen content, to limit the Nox s coming out.
4. Multiple gas pipes, non-central combustion, in case of high oxidation.
5. Use 3 pcs servo motor, control supporting-air flow, gas flow and smoke flow ratio accurately.
6. Use flange and high temperature proof gasket to connect with boiler.
7. Three-phase electric motor to run fan.
8. UV photocell checks the flame.
9. Electrical plant protection rating IP40.

RMR1200/1500/1800FGR

RAMVER FUEL GAS EXTERNAL CIRCULATION COMBUSTION SYSTEM

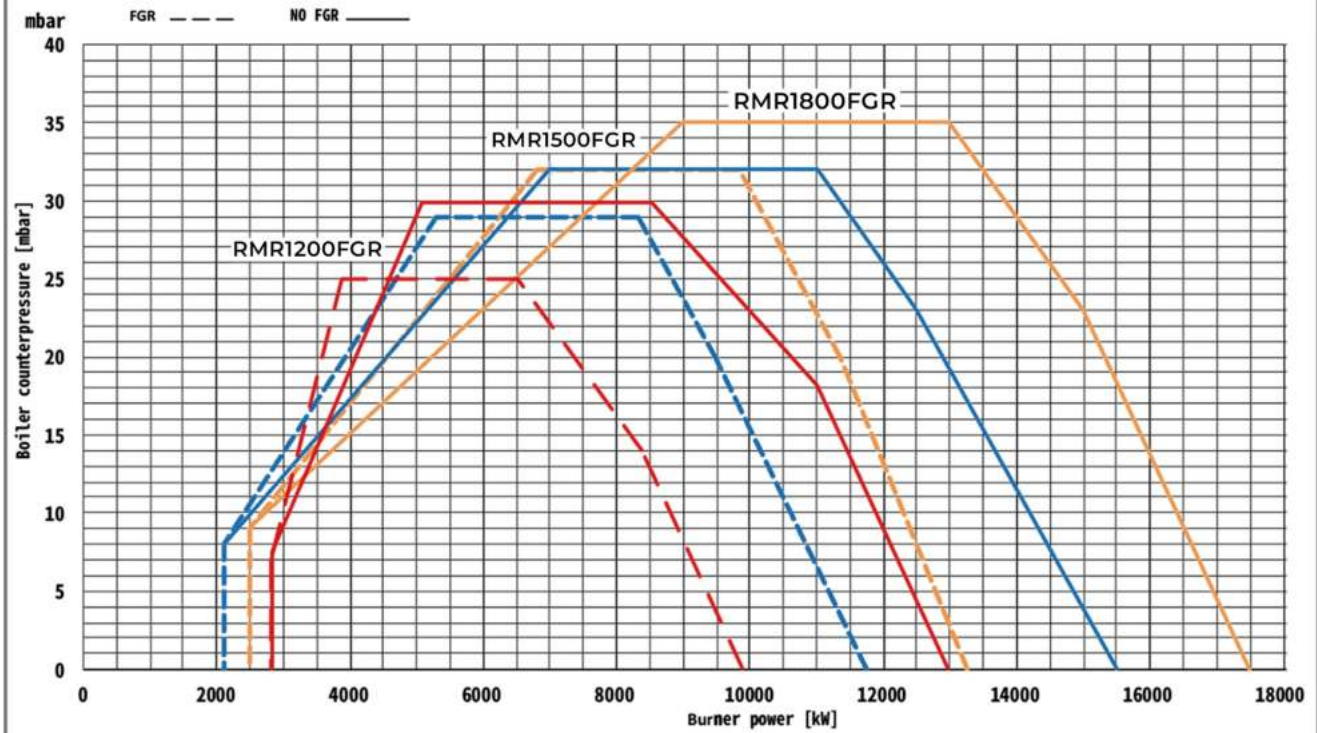

| Power | Model | Power Supply | Motor Power | Packing Size LxPxH | Net Weight |
|---------------|------------|--------------|-------------|--------------------|------------|
| 2700~9850 KW | RMR1200FGR | 380V 50Hz | 37 KW | 2470x1810x1765 mm | - |
| 2100~11740 KW | RMR1500FGR | 380V 50Hz | 45 KW | 2470x1810x1765 mm | - |
| 2500~13260 KW | RMR1800FGR | 380V 50Hz | 55 KW | 2470x1810x1765 mm | - |

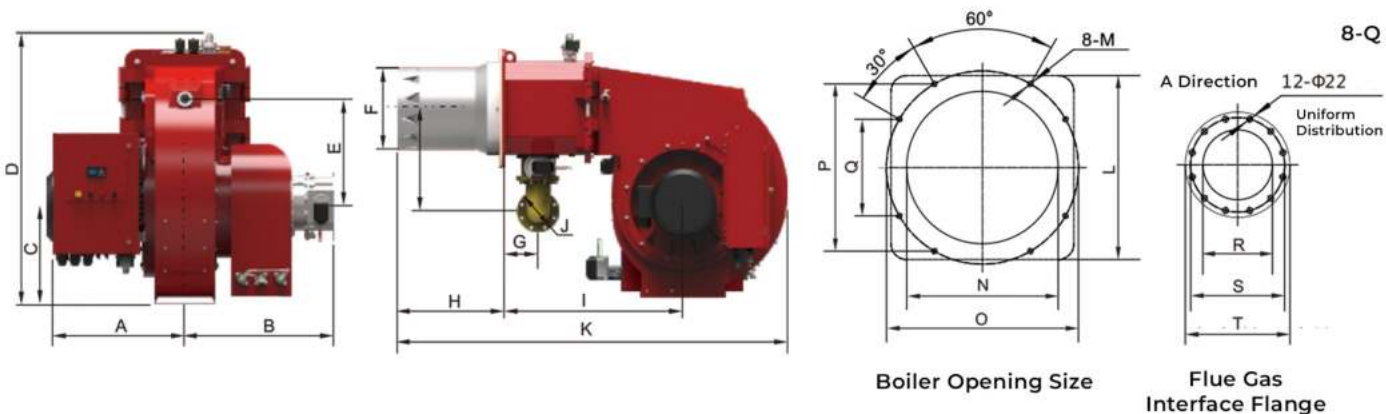

| Model | RMR1200FGR | RMR1500FGR | RMR1800FGR |
|-------|------------|------------|------------|
| A | 812 mm | 812 mm | 812 mm |
| B | 875 mm | 877 mm | 877 mm |
| C | 568 mm | 1130 mm | 1130 mm |
| D | 1578 mm | 1578 mm | 1578 mm |
| E | 562 m | 614 m | 614 m |
| F | φ 545 mm | φ 544 mm | φ 544 mm |
| G | φ 230 mm | φ 230 mm | φ 230 mm |
| H | 662 mm | 619 mm | 619 mm |
| I | 1099 mm | 1100 mm | 1100 mm |
| J | DN125 mm | DN125 mm | DN125 mm |
| K | φ 2391 mm | φ 2350 mm | φ 2350 mm |
| L | φ 700 mm | φ 700 mm | φ 700 mm |
| M | 8-M18 m | 8-M18 m | 8-M18 m |
| N | φ 580 mm | φ 580 mm | φ 580 mm |
| O | φ 735 mm | φ 735 mm | φ 735 mm |
| P | 637 mm | 637 mm | 637 mm |
| Q | 368 mm | 368 mm | 368 mm |
| R | φ 259 mm | φ 259 mm | φ 259 mm |
| S | φ 350 mm | φ 350 mm | φ 350 mm |
| T | φ 390 mm | φ 390 mm | φ 390 mm |

RMR40GP

RAMVER FULL PREMIXED SURFACE COMBUSTION SYSTEM



BEST PERFORMANCE



STABLE & DURABLE



WORK EFFICIENCY



EASY OPERATION



Product Description

1. Metal fiber surface combustion, both of sides occurs the combustion.
2. Gas and air premix.
3. Full premix combustion, fast speed of combustion. short flame, it could not result with NOx.
4. Emission of NOx could be low to 18 mg/m'.
5. Electronic modulation operation.
6. Gas and air flow ratio is controlled by two servo motor separately.
7. There has filter device in supporting air, it is avoid of block, because of long time burner head operation.
8. Lonization electrode checks the flame.
9. Electrical plant protection rating IP40.

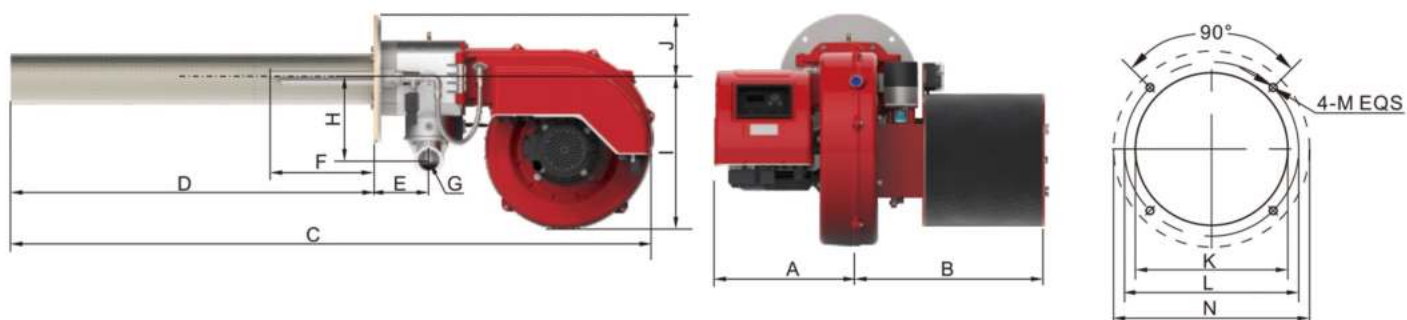

| Model | RMR40GP |
|-------|------------|
| A | 300 mm |
| B | 500 mm |
| C | 1630 mm |
| D | 791 mm |
| E | 180 mm |
| F | 200 mm |
| G | G1 1/2" mm |
| H | 206 mm |
| I | 362 mm |
| J | 146 mm |
| K | φ 160 mm |
| L | φ 185 mm |
| M | 4-M12 mm |
| N | φ 215 mm |

| | |
|--------------------|----------------|
| Power | 45~370 KW |
| Model | RMR40GP |
| Power Supply | 230V 50Hz |
| Motor Power | 0.45 KW |
| Packing Size LxPxH | 740x680x570 mm |
| Net Weight | 39 Kg |

Proportional Adjustment Function

If order Modulation device RWF40 or DC1020 set, burner can turn to modulation regulation.

Standard Accessories
Valve-the partnership with the boiler.

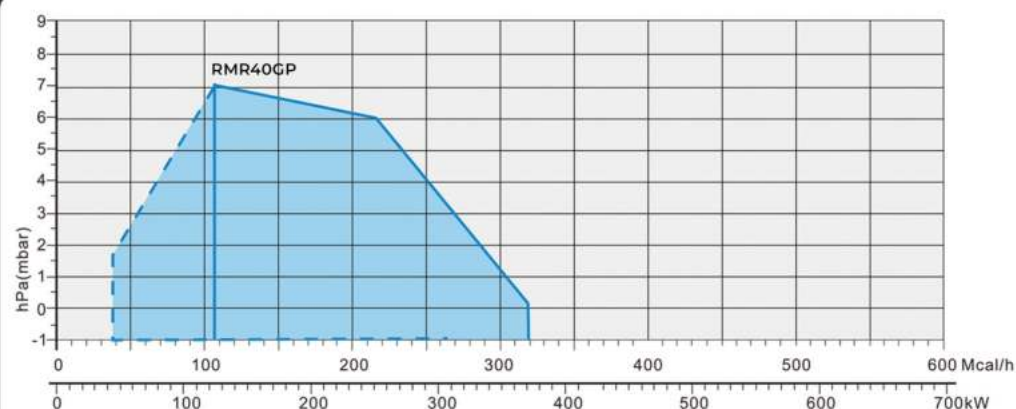

RMR85/120GP

RAMVER FULL PREMIXED SURFACE COMBUSTION SYSTEM



BEST PERFORMANCE



STABLE & DURABLE



WORK EFFICIENCY



EASY OPERATION



Product Description

1. Metal fiber surface combustion, both of sides occurs the combustion.
2. Gas and air premix.
3. Full premix combustion, fast speed of combustion. short flame, it could not result with NOx.
4. Emission of NOx could be low to 18 mg/m'.
5. Electronic modulation operation.
6. Gas and air flow ratio is controlled by two servo motor separately.
7. There has filter device in supporting air, it is avoid of block, because of long time burner head operation.
8. Lonization electrode checks the flame.
9. Electrical plant protection rating IP40.

| Power | Model | Power Supply | Motor Power | Packing Size LxPxH | Net Weight |
|-------------|----------|--------------|-------------|--------------------|------------|
| 150~688 KW | RMR85GP | 380V 50Hz | 1.5 KW | 1000x1010x755 mm | 78 Kg |
| 300~1040 KW | RMR120GP | 380V 50Hz | 2.2 KW | 1000x1010x755 mm | 81 Kg |

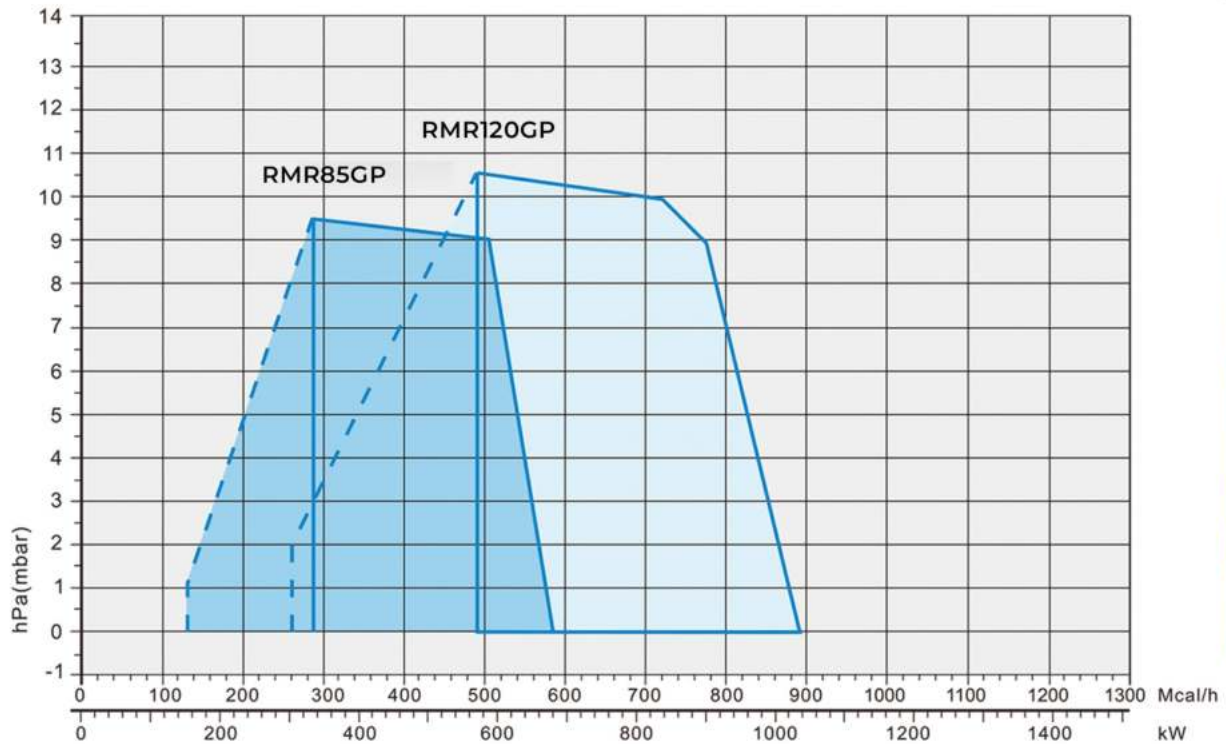

Proportional Adjustment

If order Modulation device RWF40 or DC1020 set, burner can turn to modulation regulation.

Standard Accessories

Valve-the partnership with the boiler.

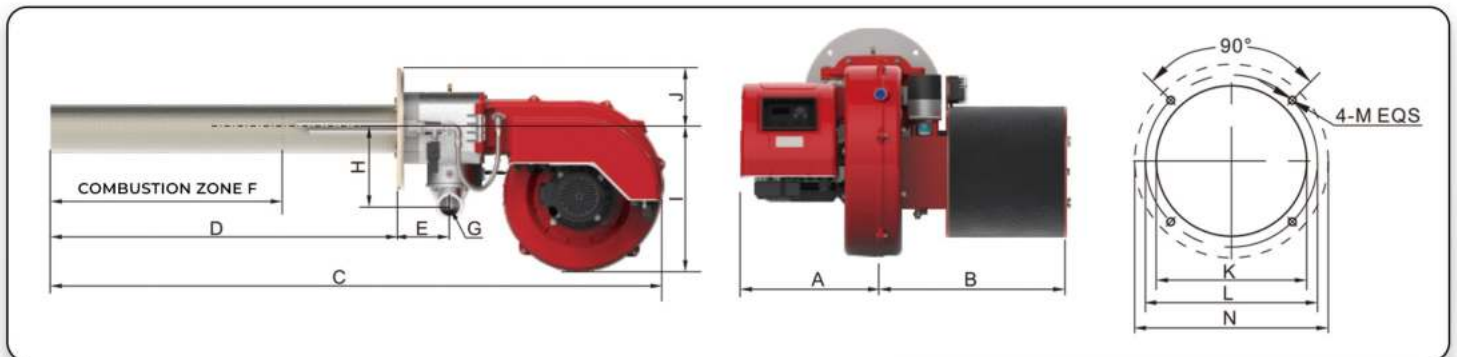

| Model | RMR85GP | RMR120GP |
|-------|-----------|----------|
| A | 352 mm | 352 mm |
| B | 524 mm | 528 mm |
| C | 1825 mm | 2097 mm |
| D | 1029.5 mm | 1300 mm |
| E | 155 mm | 155 mm |
| F | 694 mm | 966 mm |
| G | G2" mm | G2" mm |
| H | 231 mm | 231 mm |
| I | 427.5 mm | 427.5 mm |
| J | 180 mm | 180 mm |
| K | φ 280 mm | φ 280 mm |
| L | φ 320 mm | φ 320 mm |
| M | 4-M12 m | 4-M12 m |
| N | φ 360 mm | φ 360 mm |

RMR210/250GP

RAMVER FULL PREMIXED SURFACE COMBUSTION SYSTEM



BEST PERFORMANCE



STABLE & DURABLE



WORK EFFICIENCY



EASY OPERATION



Product Description

1. Metal fiber surface combustion, both of sides occurs the combustion.
2. Gas and air premix.
3. Full premix combustion, fast speed of combustion. short flame, it could not result with NOx.
4. Emission of NOx could be low to 18 mg/m'.
5. Electronic modulation operation.
6. Gas and air flow ratio is controlled by two servo motor separately.
7. There has filter device in supporting air, it is avoid of block, because of long time burner head operation.
8. Ionization electrode checks the flame.
9. Electrical plant protection rating IP40.

| Power | Model | Power Supply | Motor Power | Packing Size LxPxH | Net Weight |
|-------------|----------|--------------|-------------|--------------------|------------|
| 300~1488 KW | RMR210GP | 380V 50Hz | 4.5 KW | 1000x1010x755 mm | 89 Kg |
| 570~1920 KW | RMR250GP | 380V 50Hz | 5.5 KW | 1000x1010x755 mm | 125 Kg |

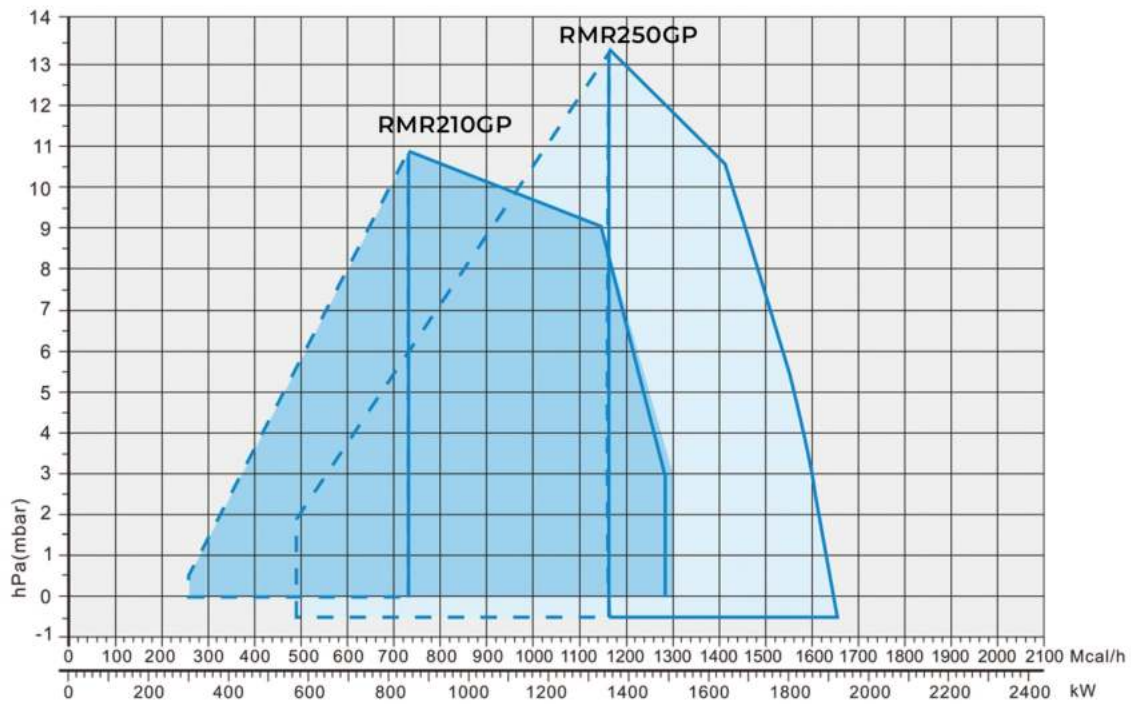

Proportional Adjustment

If order Modulation device RWF40 or DC1020 set, burner can turn to modulation regulation.

Standard Accessories

Valve-the partnership with the boiler.

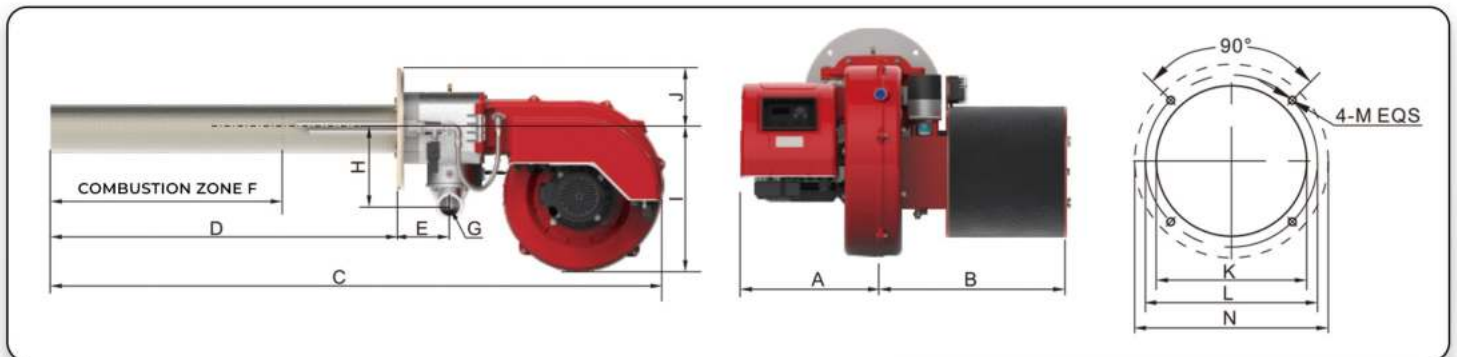

| Model | RMR210GP | RMR250GP |
|-------|----------|----------|
| A | 403 mm | 403 mm |
| B | 535 mm | 535 mm |
| C | 1785 mm | 2050 mm |
| D | 988 mm | 1252 mm |
| E | 155 m | 155 m |
| F | 660 mm | 922 mm |
| G | G2" mm | G2" mm |
| H | 231 mm | 231 mm |
| I | 427.5 mm | 427.5 mm |
| J | 180 mm | 180 mm |
| K | φ 280 mm | φ 280 mm |
| L | φ 320 mm | φ 320 mm |
| M | 4-M12 m | 4-M12 m |
| N | φ 360 mm | φ 360 mm |

RMR400/600GP

RAMVER FULL PREMIXED SURFACE COMBUSTION SYSTEM



BEST PERFORMANCE



STABLE & DURABLE



WORK EFFICIENCY



EASY OPERATION



Product Description

1. Metal fiber surface combustion, both of sides occurs the combustion.
2. Gas and air premix.
3. Full premix combustion, fast speed of combustion. short flame, it could not result with NOx.
4. Emission of NOx could be low to 18 mg/m'.
5. Electronic modulation operation.
6. Gas and air flow ratio is controlled by two servo motor separately.
7. There has filter device in supporting air, it is avoid of block, because of long time burner head operation.
8. Lonization electrode checks the flame.
9. Electrical plant protection rating IP40.

| Power | Model | Power Supply | Motor Power | Packing Size LxPxH | Net Weight |
|--------------|----------|--------------|-------------|--------------------|------------|
| 710~3560 KW | RMR400GP | 380V 50Hz | 9 KW | 1625x1070x995 mm | 562 Kg |
| 1000~5000 KW | RMR600GP | 380V 50Hz | 12.5 KW | 1625x1070x995 mm | 567 Kg |

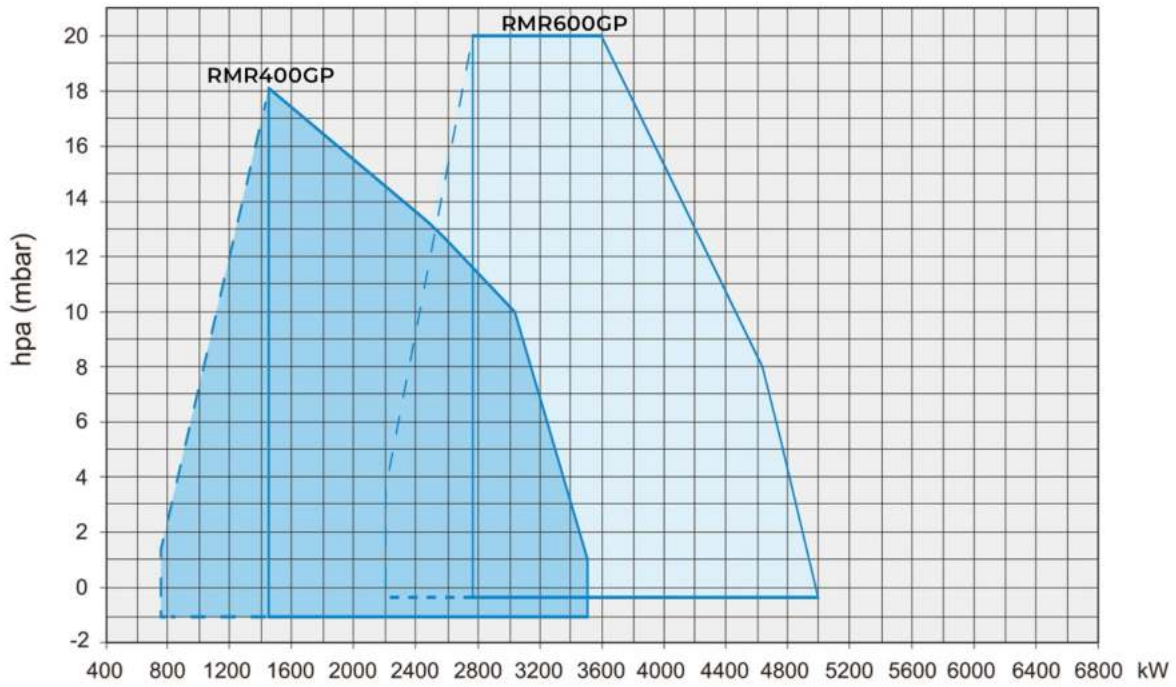

Proportional Adjustment

If order Modulation device RWF40 or DC1020 set, burner can turn to modulation regulation.

Standard Accessories

Valve-the partnership with the boiler.

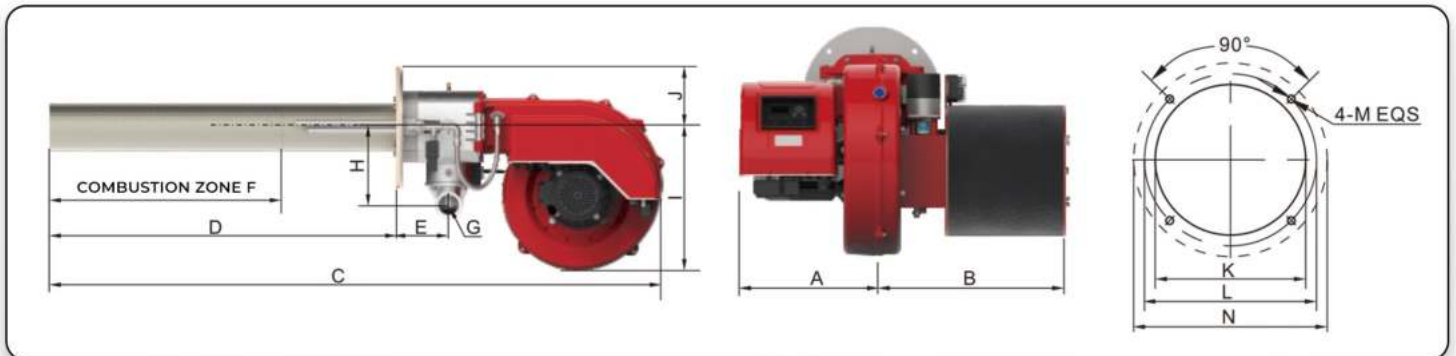

| Model | RMR400GP | RMR600GP |
|-------|----------|----------|
| A | 687 mm | 687 mm |
| B | 527 mm | 527 mm |
| C | 520 mm | 520 mm |
| D | 2413 mm | 2845 mm |
| E | 1480 mm | 1912 mm |
| F | 150 mm | 150 mm |
| G | DN80 mm | DN80 mm |
| H | 930 mm | 1270 mm |
| I | 414 mm | 414 mm |
| J | 578 mm | 578 mm |
| K | φ 475 mm | φ 475 mm |
| L | φ 550 mm | φ 550 mm |
| M | 4-M16 m | 4-M16 m |

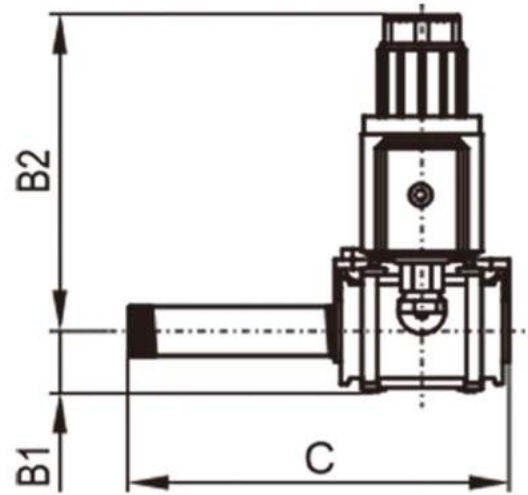
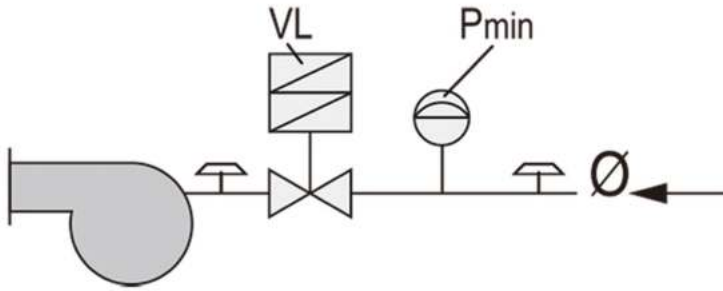

| Valve Group (Model) | F | LDU | Pct | Pmin | Location R | VL | VPS | VS | Ø | Valve Group Dimensions mm | | | Packing Size mm LxPxH | Packing Weight |
|---------------------|---|-----|-----|------|------------|----|-----|----|---------|---------------------------|-----|-----|-----------------------|----------------|
| | | | | | | | | | | B1 | B2 | C | | |
| 222 25 300 (EG15) | | | | • | | • | | | 1/2" | 26 | 135 | 162 | 200*130*180 | 1.8 Kg |
| 222 25 301 (EG15) | | | | • | | • | | | 1/2" | 26 | 135 | 162 | 200*130*180 | 1.8 Kg |
| 222 25 302 (EG25) | | | | • | | • | | | 3/4" | 30 | 183 | 184 | 240*240*260 | 3.6 Kg |
| 222 25 303 (EG15) | | | | • | | • | | | 1/2" | 26 | 135 | 162 | 200*130*180 | 1.8 Kg |
| 222 25 304 (EG25) | | | | • | | • | | | 3/4" | 30 | 183 | 184 | 240*240*260 | 3.6 Kg |
| 222 25 305 (EG30) | | | | • | | • | | | 1" | 33 | 188 | 226 | 240*240*260 | 3.6 Kg |
| 222 25 306 (EG25) | | | | • | | • | | | 3/4" | 30 | 183 | 184 | 240*240*260 | 3.6 Kg |
| 222 25 307 (EG30) | | | | • | | • | | | 1" | 33 | 188 | 226 | 240*240*260 | 3.6 Kg |
| 222 25 308 (EG40) | | | | • | | • | | | 1 1/2 " | 35 | 196 | 323 | 240*240*260 | 4.1 Kg |

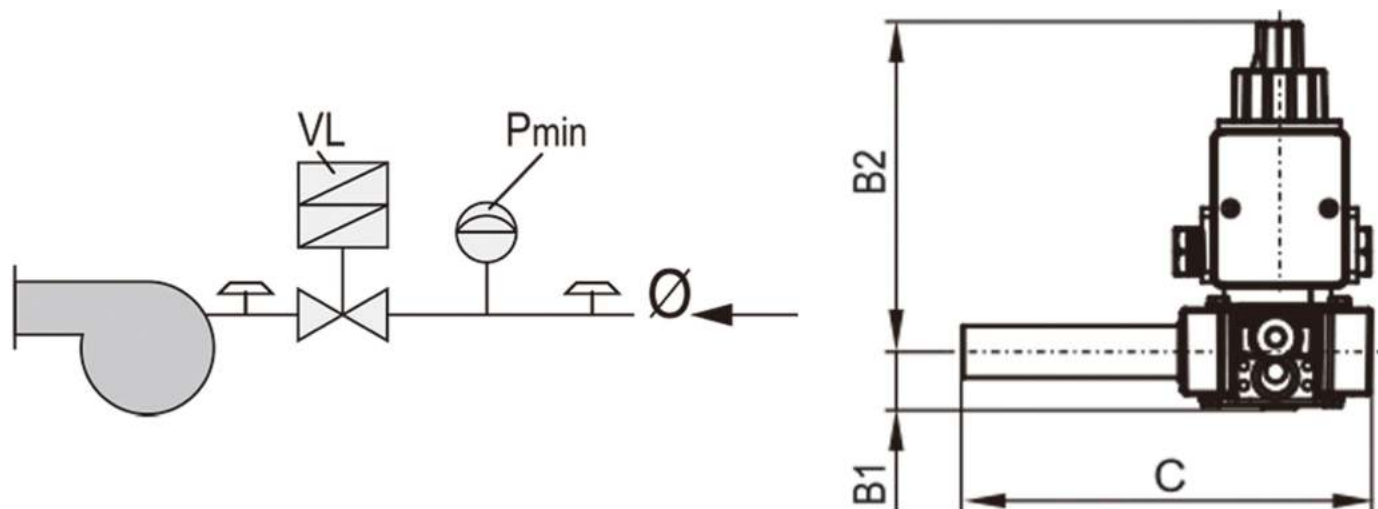

| Valve Group (Model) | F | LDU | Pct | Pmin | Location R | VL | VPS | VS | Ø | Valve Group Dimensions mm | | | Packing Size mm LxPxH | Packing Weight |
|---------------------|---|-----|-----|------|------------|----|-----|----|--------|---------------------------|-----|-----|-----------------------|----------------|
| | | | | | | | | | | B1 | B2 | C | | |
| 222 25 350 (LN205) | | | | • | | • | | | 1/2" | 23 | 109 | 162 | 240*225*190 | 1.9 Kg |
| 222 25 351 (LN205) | | | | • | | • | | | 1/2" | 23 | 109 | 162 | 240*225*190 | 1.9 Kg |
| 222 25 352 (LN207) | | | | • | | • | | | 3/4" | 27 | 130 | 190 | 240*225*190 | 3.6 Kg |
| 222 25 353 (LN205) | | | | • | | • | | | 1/2" | 23 | 109 | 162 | 240*225*190 | 1.9 Kg |
| 222 25 354 (LN207) | | | | • | | • | | | 3/4" | 27 | 130 | 190 | 240*225*190 | 3.6 Kg |
| 222 25 355 (LN210) | | | | • | | • | | | 1" | 32 | 132 | 225 | 240*225*190 | 3.6 Kg |
| 222 25 356 (LN207) | | | | • | | • | | | 3/4" | 27 | 130 | 190 | 240*225*190 | 3.6 Kg |
| 222 25 357 (LN210) | | | | • | | • | | | 1" | 32 | 132 | 225 | 240*225*190 | 3.6 Kg |
| 222 25 358 (LN215) | | | | • | | • | | | 1 1/2" | 45 | 169 | 336 | 310*280*260 | 4.1 Kg |
| 222 25 359 (LN220) | | | | • | | • | | | 2" | 52 | 171 | 355 | 310*280*260 | 7.4 Kg |

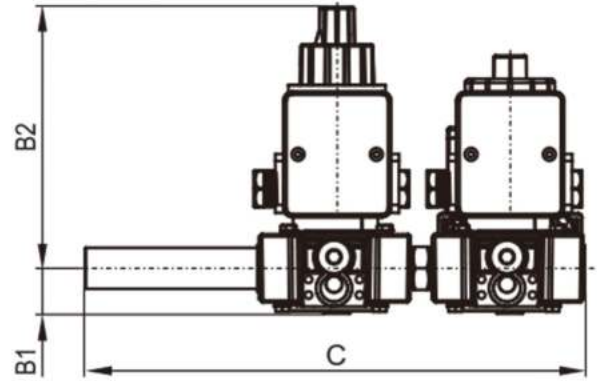
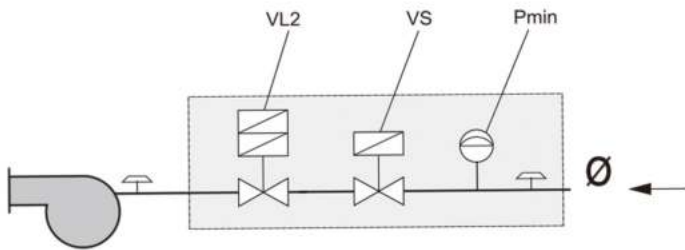

| Valve Group (Model) | F | CTV | Pct | Pmax | Position Pmin | VL 2 | VS | Ø | Valve Group Dimensions mm | | | Packing Size mm LxPxH | Packi ng Weigh t |
|----------------------------|---|-----|-----|------|---------------|------|-----|-----|---------------------------|-----|-----|-----------------------|------------------|
| | | | | | | | | | B1 | B2 | C | | |
| 222 25 450 (LN210+LN210LE) | | | | | • | 1" | 1" | 1" | 23 | 134 | 259 | 310*280*260 | 8 Kg |
| 222 25 451 (LN215+LN215LE) | | | | | • | 1½" | 1½" | 1½" | 45 | 203 | 510 | 420*250*300 | 13.5 Kg |
| 222 25 452 (LN220+LN220LE) | | | | | • | 2" | 2" | 2" | 92 | 205 | 545 | 420*250*300 | 13.5 Kg |
| 222 25 453 (LN215+LN215LE) | | | | | • | 1½" | 1½" | 1½" | 45 | 203 | 510 | 420*250*300 | 13.5 Kg |
| 222 25 454 (LN220+LN220LE) | | | | | • | 2" | 2" | 2" | 52 | 205 | 545 | 420*250*300 | 13.5 Kg |
| 222 25 455 (LN220+LN220LE) | | | | | • | 2" | 2" | 2" | 52 | 205 | 545 | 420*250*300 | 13.5 Kg |

| | |
|------|--------------------------------|
| CTV | Detection |
| F | Filter |
| LDU | Leak detection |
| Pct | Leak detection Pressure switch |
| Pmax | Maximum pressure Switch |
| Pmin | Minimum pressure Switch |

| | |
|-----|---|
| PMC | Minimum pressure and leak detection pressure switch |
| R | Regulator |
| RF | Pressure regulator with filter |
| RFP | Pressure regulator with filter for ignition valve block |

| | |
|-----|------------------------------|
| RP | Pneumatic Pressure Regulator |
| VF | Butterfly Valve |
| VL | Valve |
| VL2 | Stage Operating Valve |
| VLP | Operating Valve |
| VP | Ignition Valve |

| | |
|----------|-------------------------------|
| VPS/DSLC | VPS/DSLC |
| VS | Safety Valve |
| VSP | Ignition Safety Valve |
| | Valve Block Inlet Diameter |
| 1 | Main Valve Group Diameter |
| 2 | Ignition Valve Group Diameter |

ACCESSORIES FOR CONNECTING THE BURNER TO THE MAIN GAS LINE



| Maximum Inlet Pressure mbar | 500~1000 | | | 6000 | | |
|-----------------------------|---------------|----------|--------------------|---------------|-----------|--------------------|
| | Serial Number | Model | Interface Diameter | Serial Number | Model | Interface Diameter |
| Gas Pressure Regulator | 221 27 292 | 70609/CE | 1/2" | 221 27 298 | 70603F/CE | DN40 |
| | 221 27 293 | 70608/CE | 3/4" | 221 27 299 | 70631F/CE | DN50 |
| | 221 27 294 | 70602/CE | 1" | 221 27 300 | 70610F/CE | DN65 |
| | 221 27 295 | 70604/CE | 1 ¼" | 221 27 301 | 70620F/CE | DN80 |
| | 221 27 296 | 70603/CE | 1 ½" | 221 27 302 | 70640F/CE | DN100 |
| | 221 27 297 | 70601/CE | 2" | 221 27 303 | 70650F/CE | DN125 |
| | | | | 221 27 304 | 70660F/CE | DN150 |

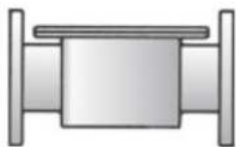

| | Serial Number | Model | Interface Flange |
|------------|---------------|--------------|------------------|
| Filter | 222 26 100 | FGDR15/CE | 1/2" |
| | 221 27 101 | FGDR20/CE | 3/4" |
| | 221 27 102 | FGDR25/CE | 1" |
| | 221 27 103 | FGDR32/CE | 1 ¼" |
| | 221 27 104 | FGDR40/CE | 1 ½" |
| | 221 27 105 | FGDR50/40/CE | 2" |
| | 221 27 106 | FSDR65/CE | DN65 |
| | 221 27 107 | FSDR80/CE | DN80 |
| | 221 27 108 | STR100D/CE | DN100 |
| | 221 27 109 | STR125D/CE | DN125 |
| 221 27 110 | STR150D/CE | DN150 | |

ACCESSORIES FOR CONNECTING THE BURNER TO THE MAIN GAS LINE

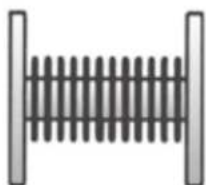

Damping and Compensating Sections (DIN 30681 Stainless Steel)

| | Serial Number | Model | Interface Flange |
|---|---------------|----------|------------------|
| Damping and Compensating Sections (DIN 30681 Stainless Steel) | 221 19 244 | BTPZ-244 | 1/2" mm |
| | 221 19 245 | BTPZ-245 | 3/4" mm |
| | 221 19 246 | BTPZ-246 | 1" mm |
| | 221 19 247 | BTPZ-247 | 1 1/4" mm |
| | 221 19 248 | BTPZ-248 | 1 1/2" mm |
| | 221 19 249 | BTPZ-249 | 2" mm |
| | 221 19 250 | BTPZ-250 | DN65 |
| | 221 19 251 | BTPZ-251 | DN80 |
| | 221 19 252 | BTPZ-252 | DN100 |
| | 221 19 253 | BTPZ-253 | DN125 |
| | 221 19 254 | BTPZ-254 | DN150 |
| | 221 19 255 | BTPZ-255 | DN200 |

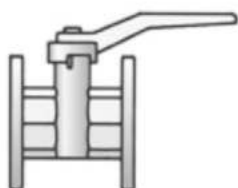
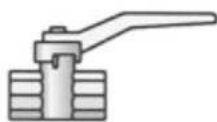

Ball Valve

| | Serial Number | Model | Interface Flange |
|------------|---------------|----------|------------------|
| Ball Valve | 221 16 300 | BTQF-300 | 1/4" |
| | 221 16 302 | BTQF-302 | 3/8" mm |
| | 221 16 303 | BTQF-303 | 1/2" mm |
| | 221 16 312 | BTQF-312 | 3/4" mm |
| | 221 16 313 | BTQF-313 | 1" mm |
| | 221 16 314 | BTQF-314 | 1 1/2" mm |
| | 221 16 315 | BTQF-315 | 2" |
| | 221 16 316 | BTQF-316 | DN40 |
| | 221 16 317 | BTQF-317 | DN50 |
| | 221 16 318 | BTQF-318 | DN65 |
| | 221 16 319 | BTQF-319 | DN80 |
| | 221 16 320 | BTQF-320 | DN100 |
| | 221 16 321 | BTQF-321 | DN125 |
| | 221 16 322 | BTQF-322 | DN150 |
| | 221 16 323 | BTQF-323 | DN200 |

INDOTARA[®]

PT. INDOTARA PERSADA

Our Marketing Office and After Sales Service Center

Head Office

50/F, Menara BCA Grand Indonesia
Jl. M.H. Thamrin No.1
Jakarta Pusat 10310
021 - 5011 2228
dgm@indotara.id



Semarang Office

Wisma HSBC Lt. 6 Suite 609
Jl. Gajah Mada No.135
Semarang, Jawa Tengah 50134
024 - 40 300 893
smg.dgm@indotara.id



Marketing Office

APL Tower 6th Floor No. 6 Central Park,
Jl. Letjen S. Parman Kav 28,
Jakarta Barat - 11440
021 - 5011 2228
dgm@indotara.id



Medan Office

Sutomo Tower Lantai 5H
Jl. Sutomo Ujung No.28,
Kota Medan, Sumatera Utara 20235
061 - 50 300 595
mdn.dgm@indotara.id



Graha Indotara

Millenium Industrial Estate
Jl. Millenium 22 Blok R3 No. 1
Cikupa, Tangerang - Banten 15720
021 - 5011 2228
dgm@indotara.id



Makassar Office

Fajar Graha Pena Lt. 5
Jl. Urip Sumoharjo No. 20,
Makassar - South Sulawesi 90234
021 - 5011 2228
mks.dgm@indotara.id



Bandung Office

Wisma HSBC Lt. 6 Suite B
Jl. Asia Afrika No. 116
Bandung, Jawa Barat 40112
021 - 5011 2228
bdg.dgm@indotara.id



Balikpapan Office

Panin Tower Lt. 8 - Grand Sudirman
Jl. Jendral Sudirman No.7 Klandasan Ilir,
Balikpapan Kota, Kalimantan Timur 76114
021 - 5011 2228
bpp.dgm@indotara.id



Surabaya Office

Japfa Indoland Center, Tower I Lt. 10/1008
Jl. Jendral Basuki Rahmat 129-137
Surabaya 60271
031 - 3360 1491
sby.dgm@indotara.id



Bali Office

Benoa Square Lt. 2
Jl. Bypass Ngurah Rai No. 21 A Kedonganan,
Kuta Badung - Bali Indonesia 80361
021 - 5011 2228
bali.dgm@indotara.id



Yogyakarta Office

Hartono Mall Yogyakarta Lt. 3
Kaliwaru, Condongcatur,
Sleman, Yogyakarta 55281
021 - 5011 2228
yog.dgm@indotara.id



Singapore Office

Marina Bay Financial Centre Tower 3
17F, 12 Marina Boulevard
Singapore - 018982
021 - 5011 2228
sing.dgm@indotara.id

